



Endura Door System Installation Instructions

These instructions apply to the following Door Systems:



Installation Checklist

- Clean, dry, level, and solid subfloor (1)
- Three beads of caulk under the Sill (2)
- Ensure consistent margins (5)
- Adjust the Sill Cap or Door Bottom (8)
- Install Simple Solution® Corner Pads (8)
- Caulk corner of Sill and Jamb (9)
- Position & Install Astragal (French Units) (10)
- Caulk around door unit and use flashing (11)

Note: This instruction assumes that an appropriate weather-resistive barrier, as required by local building codes, is installed per manufacturer's instructions around the rough opening prior to door installation.

Note: This instruction applies to both inswing and outswing doors, except where noted.

1 Preparing the Rough Opening

- Are the walls straight?
- Is the rough opening framing plumb & level?
- Is the subfloor clean, dry, level and solid?

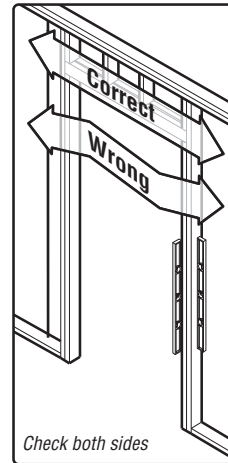

If you are using a height plate to bring the sill up to the level of the finished floor covering:

Be sure that it is at least as wide as the sill and as long as the rough opening.

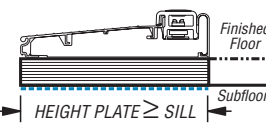

Be sure to caulk thoroughly under and around the height plate.

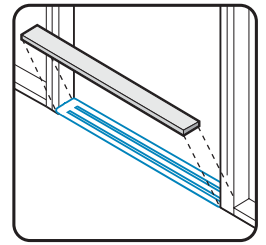

2 Pre-Caulking Subfloor for Sill

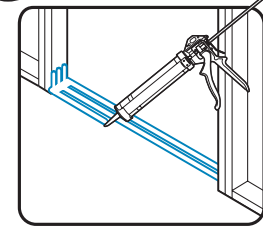

Put three heavy beads (1/2" wide) of polyurethane or 100% silicone sealant on the subfloor or height plate and studs as shown. Put enough caulk at the sides to completely cover the bottom of the side jamb. Pivot door unit directly into position.

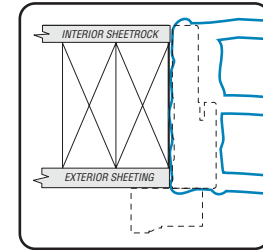

Apply 1/2" bead of polyurethane or 100% silicone sealant to sheathing side of brickmould or exterior trim.

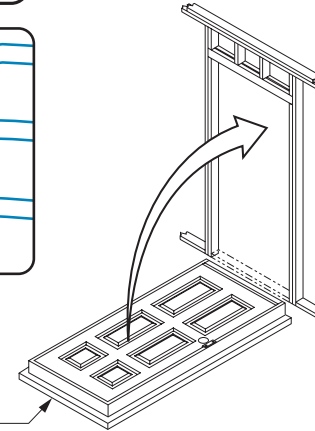

2a Optional - Sill Pan

A SureSill sill pan may be used in Endura Door Systems, but is not required.

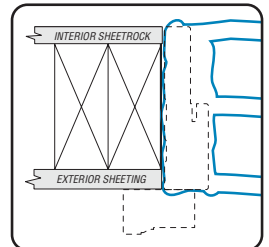
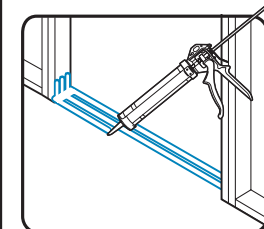

1. Put three heavy beads (1/2" wide) of polyurethane or 100% silicone sealant on the subfloor or height plate and studs as shown. Put enough caulk at the sides to completely cover the bottom of the side jamb.

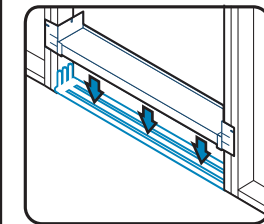

2. Place and secure SureSill™ Pan according to separately issued Endura Instructions.

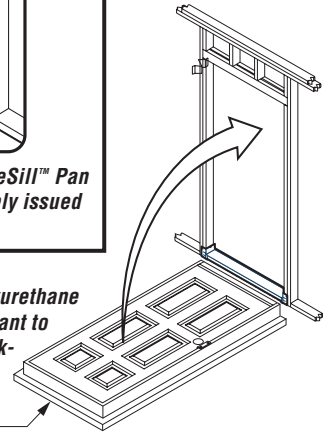

3. Apply 1/2" bead of polyurethane or 100% silicone sealant to sheathing side of brickmould or exterior trim. Pivot door unit directly into position.

4. Seal Interior Edges

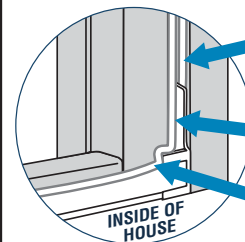

Apply sealant between the rough opening and the jamb, 6" above the end caps.
NOTE: Backer rod may be needed.

Apply sealant between the back edge of the end cap and the jamb.

Apply sealant between the back edge of the sill pan and the sill.

3 Position Unit in Rough Opening

Center door unit in rough opening. Secure fasteners through thick part of jambs as shown, just above the hinge positions on the hinge jamb. Do not fully seat. Use 3 screws for 7/0 and shorter units, and 4 screws for 7/5 and taller units.

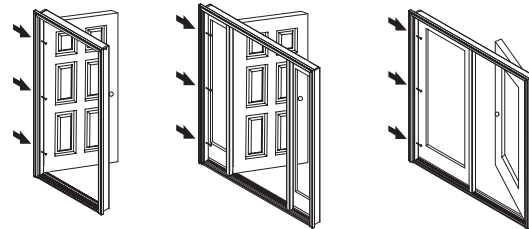

Single Units: Fasten Hinge Jamb first

Sidelite Units: Fasten Sidelite Jamb on Hinge Side first

French & Patio Units: Fasten Jamb on fixed or passive side panel first

For systems with brickmould or other exterior trim, assure that back side of moulding is up against exterior sheeting.

Note: Do not secure door unit through brickmould or other exterior trim.

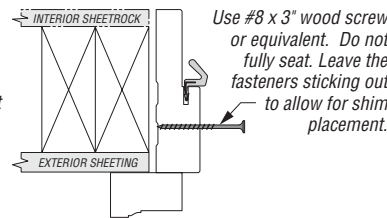

Use #8 x 3" wood screw or equivalent. Do not fully seat. Leave the fasteners sticking out to allow for shim placement.

4 Shim and Secure Hinge Jamb

Check hinge jamb for plumb and true with a 6-foot or longer level.

Place shims at same position as fasteners. Adjust to take up space between jamb and rough opening. **Note:** In some cases, the rough opening is plumb and allows the door jamb to be placed against the rough opening. Shims on this side will not be required.

Drive a fastener through each shim and into jambs, then remove excess shim.

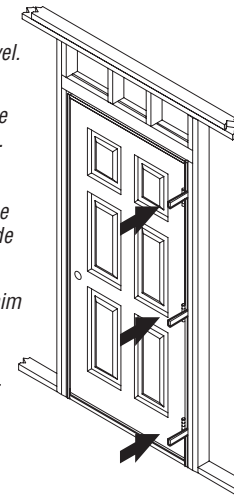
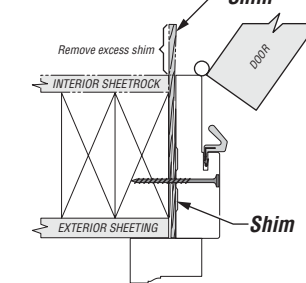

Endura Products, Inc.

8817 West Market St. • Colfax, NC 27235 • (800) 334-2006

www.enduraproducts.com

5 Shim & Secure Opposite Jamb

Install fasteners on thick part of jamb, opposite hinge jamb fasteners. Install shims at fastener locations and adjust to insure a 1/8" consistent margin between door panel and jamb.

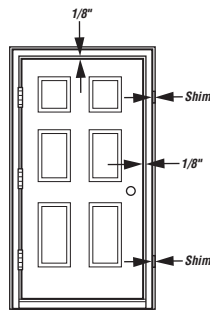

Adjust the frame so it is flush with the face of the door.

Check the weatherstrip contact for even compression all around the door.

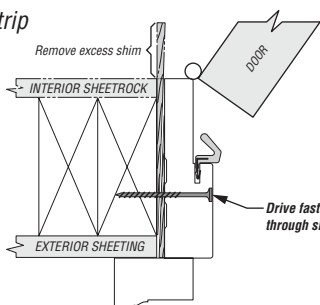

Drive fasteners through each shim and jamb at locations of top and bottom shims, then remove excess shims.

6 Securing Hinges and Lockset Hardware

Remove the top screw from each hinge and replace with a #10 x 2-1/2" screw. These screws will run through hinge jamb and into the rough stud, preventing door sag. Ensure shims are placed at screw location.

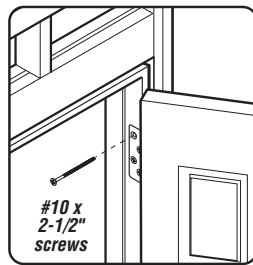

Install lockset hardware.

With door closed, shim behind strike and deadbolt plates to maintain proper margins.

Secure each plate with two #10 x 2-1/2" screws through the shim and into the rough stud. Remove excess shim.

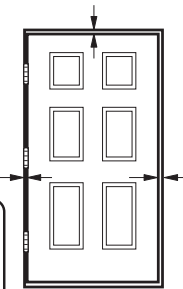
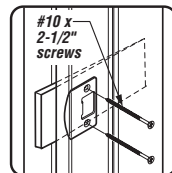

7 Fastening Header

Secure fasteners through thick part of header. Use shim at each location indicated (X) to maintain proper margin.

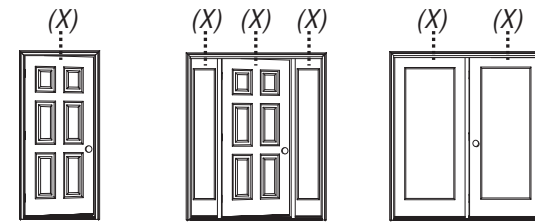

Single Doors Single & Double Continuous Sidelite Units French & Patio Units

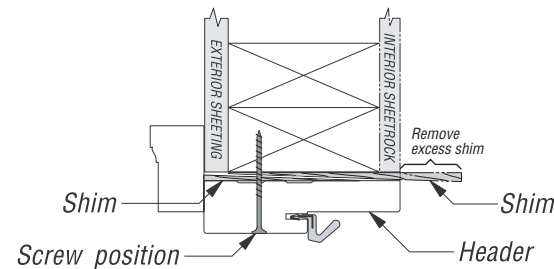

8 Adjust Sill and Check Corner Pads

If necessary, adjust the sill cap to ensure consistent spacing between panel and cap.

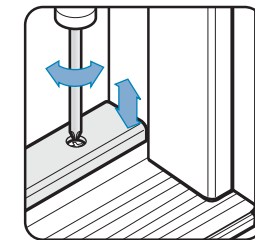
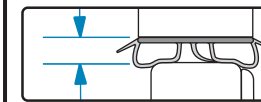

Verify proper installation of Simple Solution® Corner Pads. The raised fin of the corner pad needs to be tucked behind the weatherstrip as shown. (Both strike and hinge sides.) Pads not required on outswing jambs.

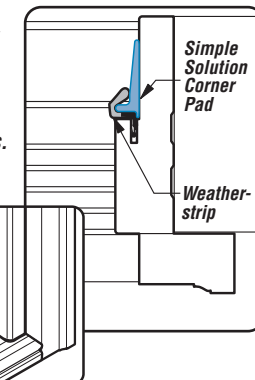

The Simple Solution Corner Pad must also contact the top surface of the sill cap.

9 Caulking Sill

Use polyurethane or 100% silicone sealant in the areas indicated.

Caulk the intersection of the aluminum sill extrusion and the jamb.

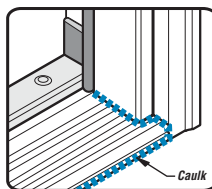

Seal front bottom edge of sill.

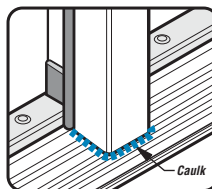

Caulk around the intersection of the mull and the door sill.

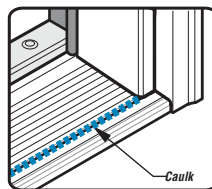

If a sill extender is installed, apply a bead of caulk where the extender meets the sill.

10 Astragal Positioning (French)

Close the passive door to verify that it is in the desired position.

Push bolt pins to contact header and sill, then mark positions for retainer holes.

Complete installation and positioning of astragal according to Endura's "Field Installation Instructions" provided with the French unit.

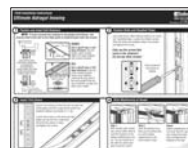

The strikes should be adjusted in the direction of door closure to assure that the strikes pull the door up to the weatherstrip tightly.

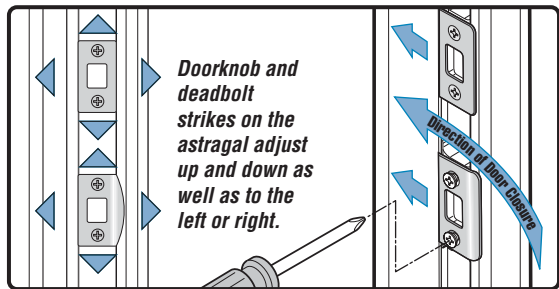

11 Weatherproofing

Caulk around the entire unit on weather-exposed side between brickmould and siding or sheathing.

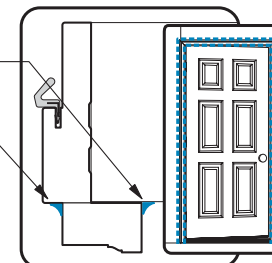

Caulk at joint of brickmould and jamb

Install flashing above protruding header trim in shingle lap fashion, or per manufacturer's instructions.

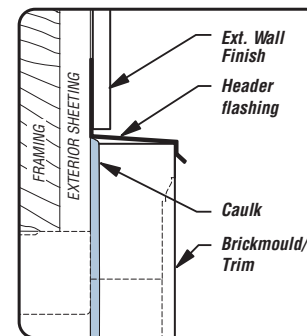

High Performance Door Systems are manufactured by:

Endura Products, Inc.
8817 West Market St. • Colfax, NC 27235 • (800) 334-2006
www.enduraproducts.com

Simple Solution is a registered trademark of Endura Products, Inc. All rights reserved.